

Fairfield Township Schools

Special Board Committee Informational Meeting
Thursday, January 27, 2022

Why Fairfield?

- Suburban neighborhood rich in culture and tradition
- Many parents of our students grew up in town and would like to give their children a similar experience
- Families move here to take advantage of quality education
- Safe and strong school system helps to maintain property values
- School system is one of the primary factors that attracts people to Fairfield
- In order to continue to provide the best education possible for your children we need to make some adjustments

Space at Stevenson

- Meeting the needs of our current student population
 - What are those needs?
 - Requiring more small group - ESL, NJTSS/RTI (8), Special Education, Speech, OT, PT
 - Special area teachers are working in classrooms on a cart.
- Proactively planning to maintain proper learning spaces
 - To optimize learning
 - Building a strong foundation, support system at Stevenson
 - Setting them up for success for Churchill and beyond

	Tiered Support	ESL	Sp. Education	HEP
Preschool	NA	NA	16/24	NA
Kindergarten	42	11	11	Infused in STEAM
Grade 1	40	4	7	Infused in STEAM
Grade 2	45	3	13	Infused in STEAM
Grade 3	54	0	22	3 (and infused in STEAM)

Specials on Carts:
Art
Music
World Language

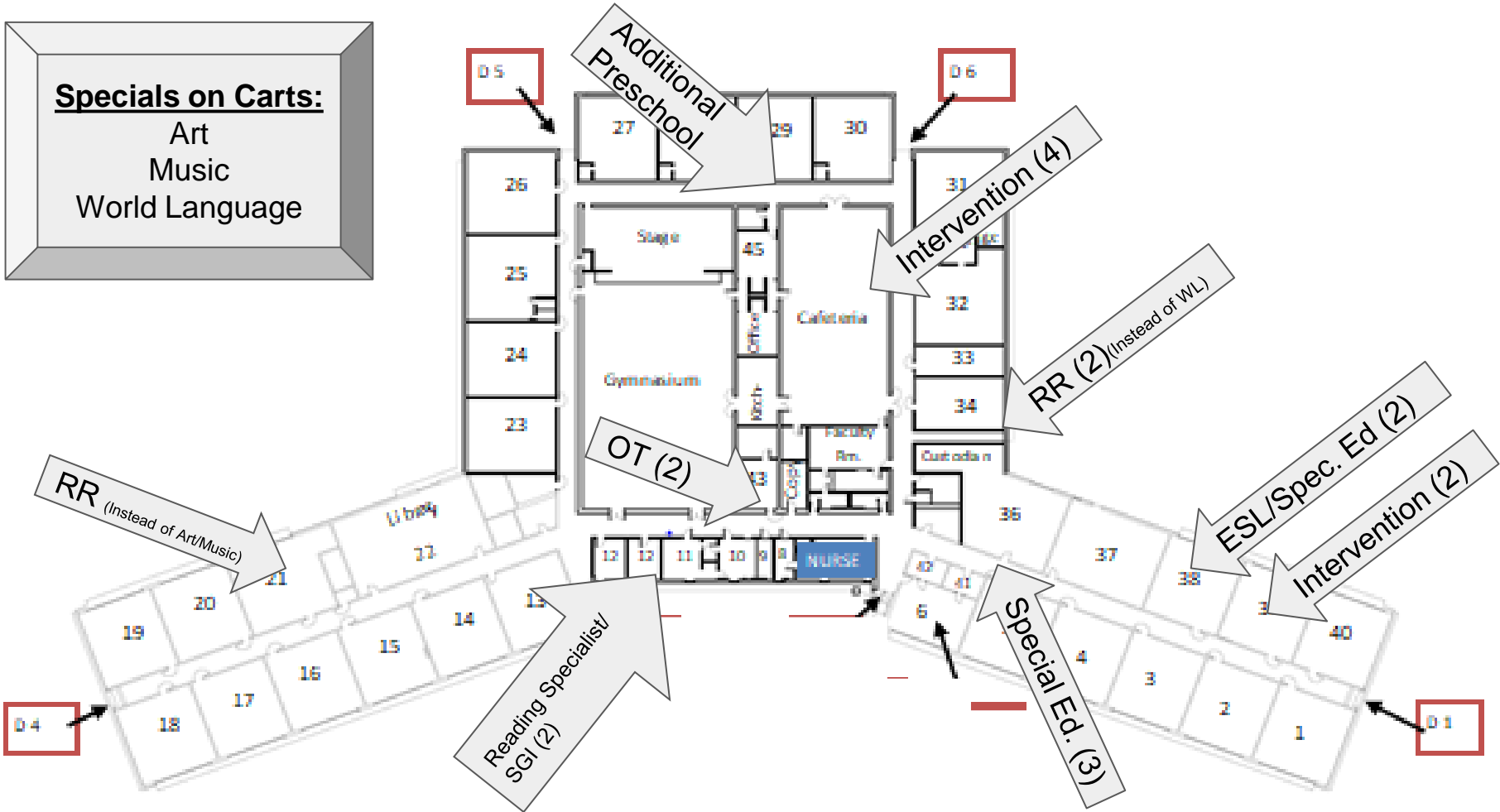

04

05

06

01

RR (Instead of Art/Music)

Reading Specialist/
SGI (2)

OT (2)

Intervention (4)

RR (2) (Instead of WL)

ESL/Spec. Ed (2)

Intervention (2)

Special Ed. (3)

Space Utilization at Churchill

- All full sized classrooms are used for full homeroom classes
 - When homerooms are in special areas, the special area teachers use the homeroom classrooms. This displaces the homeroom teacher during his/her planning period. It creates issues with regard to setting up hands-on activities and/or experiments. Additionally, it makes it difficult to reach out to parents because there is not private location to make calls.
- The former stage in the old gym/cafeteria functions as a “band room”.
 - Lessons and rehearsals run concurrently with lunch/recess periods on most days.
- Health classes are taught in the gym or cafeteria on most days because there are no classrooms available. Students sit on the floor for the period.
- Special Area Classes are on a cart and move from room to room.

Space Utilization at Churchill

- All small group instruction (SGI) rooms are used for SGI. Additionally, many of the offices in the building are used as instructional spaces for SGI as well.

	Tiered Support	ESL	Sp. Education	HEP
Grade 4	21	2 (3)	9	3
Grade 5	18	0	12	8
Grade 6	15	0	10	14

Red = Multiple classrooms needed as these are broken into small groups based on student needs and legal requirements

Space Utilization at Churchill

- The Art Room is used for Art classes in the morning and as an instructional space all afternoon.
- The Media Center is used for Media classes in the morning and as an instructional space all afternoon.
- The cafeteria is used as an instructional space in the morning and after lunch periods.
- Rooms 7, 9, 10, 16A, 17, 18, 20, 21, 24A, and the gym are all shared spaces with at least two teachers using the space on a daily basis.
- Additionally, all homeroom classrooms are used by special area teachers for their class periods.

<u>Room #</u>	<u>Usage</u>		<u>Room #</u>	<u>Usage</u>
1	6th - Math		16A	Media Center*
2	6th - Writing		16B	4th Grade
3	6th - Science		17	CST Office (x2)
4	6th - Reading		18	Speech/ESL (x2)
5	6th - Social Studies		19	Band Room
6	6th - Math		20	Special Ed. Resource
7	Art (AM)/HEP (PM)		21	Special Ed. Resource
8	Special Ed. Resource		22	4th Grade
9	Therapy Room (2)		23	4th Grade
10	5th Grade		24	Guidance Office
11	5th Grade		24A	Instr. Coaches Office (x2)
12	5th Grade		25	Nurse's Office
13	5th Grade		26	4th Grade
14	5th Grade		27	4th Grade
15	Main Office		28	MD Room
15A	Principal's Office		29	Special Ed. Resource
16	BSI (x2)			

Current Room Usage at Churchill School

*Media Center is used for Media classes in the morning, then BSI instruction in the afternoon.

<u>No Rooms:</u>
World Language
STEAM
Music

Winston S. Churchill School

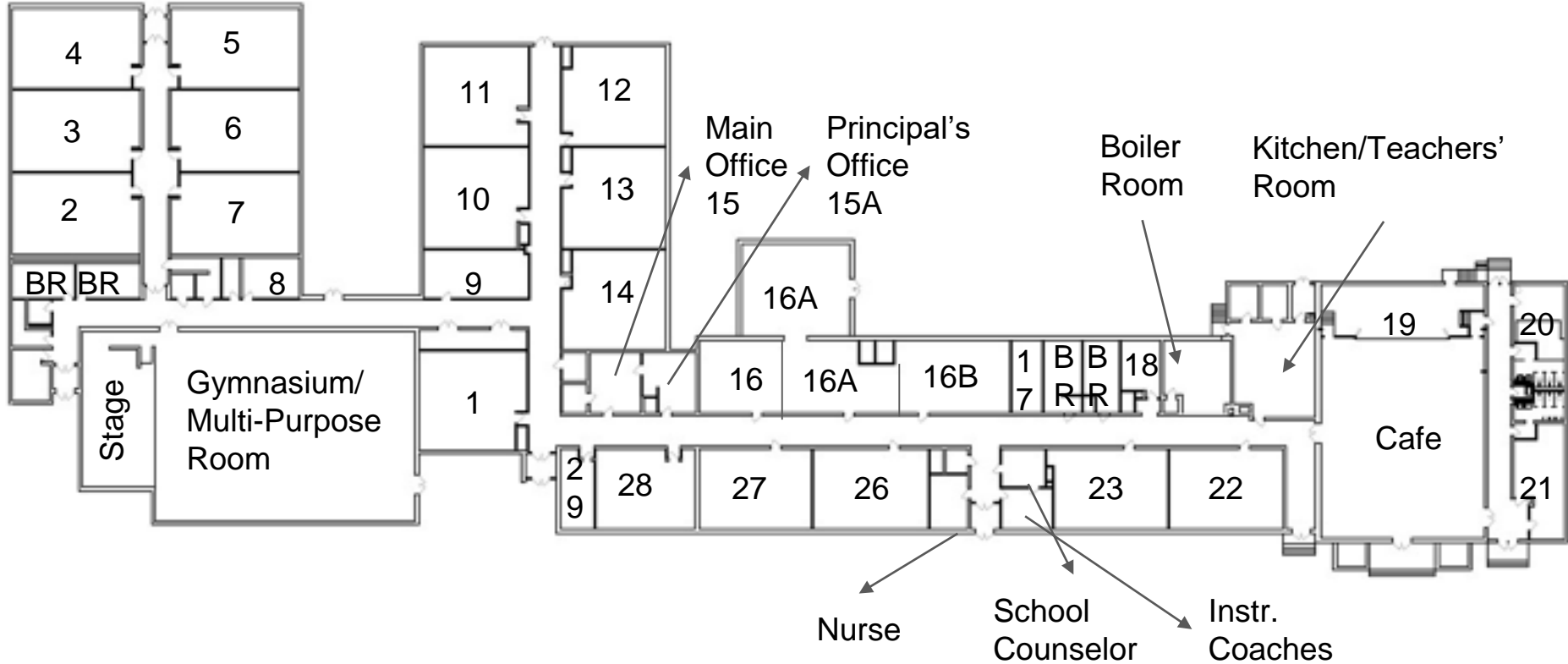

Steps Taken to Address Space Issues

- Eliminating administrative office space at Stevenson (2 phases)
- Expanding school sizes (referendum)

Considerations

- Moving Pre-K off-site
- Increase class sizes
- Reconfiguration of Grade Levels per building

Class Size Comparison

	<u>Stevenson</u>	<u>Churchill</u>	<u>Grandview</u>	<u>Gould</u>	<u>Noecker</u>	<u>EF</u>
K	19		19		16	16
1	17		15		20	16
2	19		20		20	16
3	20		20		22	16
4		16		18	21	16
5		18		20	20	16
6		20		20	18	16

The average New Jersey elementary school classroom size is 18.5 students

Sources: [National Center for Education Statistics](#), [Governing.com](#), [Statista](#).

NJDOE Rule of Thumb - sq ft of room - $\frac{1}{3}$ for furniture then 20 sq ft per person

Reducing Sections

Class Size

K	24-25
1	24-25
2	21-22
3	25-26
4	25-26
5	20-21
6	22-23

Historical Grade Level Configurations in Fairfield

- Churchill K-6 as part of the Caldwell Township School District
- Both schools K-6
- Stevenson K-6 and Churchill 1-5
- Stevenson K-4 and Churchill 5-6
- Stevenson P-3 and Churchill 4-6
- Stevenson P-2 and Churchill 3-6 (new)

Benefits of Moving Grade 3 to Churchill

- More equitable enrollment for each building
 - This keeps administrative costs down by avoiding the need for assistant principal.
- Keep the buildings equalized in enrollment. Current enrollment for Stevenson is 424 students and Churchill 290. We will lose 120 6th Grade students. If we keep the current configuration, Stevenson will continue to have approximately 430 and Churchill 260. Moving Third grade will put Stevenson at about 345 and Churchill at about 368. The numbers depend on K enrollment and the number of new students who enroll vs. students who leave.

Benefits of Moving Grade 3 to Churchill Continued

- Preschool provides the district the opportunity for more effective and efficient early intervention. This enables us to better target the instruction at the P-2 level, thereby reducing the need for services in grades 3-6.
- Frees up space at Stevenson to allow for preschool.
- When children of early childhood age, PreK-2, are grouped together in educational settings, there can be more of specific focus on the developmental needs of this age level, which are different than those of children in grades 3-6.

Benefits of Moving Grade 3 to Churchill Continued

- NJ Student Learning Standards are written in bands, K-2, 3-5, and 6-8.
 - Grade level vertical articulation within bands will be improved

- Math:

HIGHLIGHTS OF MAJOR WORK IN GRADES K-8	
K-2	Addition and subtraction – concepts, skills, and problem solving; place value
3-5	Multiplication and division of whole numbers and fractions – concepts, skills, and problem solving
6	Ratios and proportional relationships; early expressions and equations

<https://achievethecore.org/category/774/mathematics-focus-by-grade-level>

- LANGUAGE ARTS

- K - 2: DRA, Raz-kids, Foundations, Guided Reading*, modeled/mentor text curriculum
 - 3 - 6: Lexile, Achieve3000, TI/DI periods, novel-based curriculum
 - All tested grade levels will be in the same building, allowing for more efficient and effective scheduling and less impact on non-tested grades.

Benefits of Moving Grade 3 to Churchill Continued

- Upper elementary teachers are more like-minded with regard to rigor, which necessitates vertical articulation. Much more difficult in separate buildings.
- Homework amount increases in Grade 3 and is more aligned with Grade 4.

Benefits of Moving Grade 3 to Churchill Continued

- School routines, assemblies and activities can be more grade and age focused. For example, students in grades PreK-2 will not have schedules and routines interrupted during the administration of Grade 3 state testing.
- Parent involvement opportunities can focus more specifically on the developmental stages of the students in each building (PreK-2 or 3-5).
- School staff is able to focus on one specific developmental stage of children's educational growth.
- Professional Development can be more focused on the educational needs of a specific developmental stage (PreK-2 or 3-5).

Plan for 3rd Grade at Churchill

- Grade 3 moves into the hallway currently occupied by the 5th Grade.
- Grade 5 compacts from 5 sections to 4 sections due to smaller overall grade level size (80), and moves out to trailers. Trailers will have their own bathrooms. Security Officer will be present during transitions in and out of building.
- Grade 3 and 4 will use the 4th Grade Bathrooms. Grade 6 will only use the bathrooms in the 6th Grade wing bathrooms. Grade 5 will use the bathrooms in the trailers.

Plan for 3rd Grade at Churchill

- Grade 3 teachers will walk their students to Physical Education classes, Art and Media.
- Recess will be constructed to avoid any 3/6 crossover
- Assigned bus seating for 3rd and 4th graders in the front of the bus.
- Morning bus drop-off is monitored by staff in the gym.
- Parent drop-off: Grades 3 and 4 enter through the front of the building, Grades 5 and 6 enter through the rear doors.

Lunch Periods with Grade 3

- Grade 3 will eat lunch at 11:42am, then go to recess.
- Grade 4 will go to recess at 11:42am, then come inside for lunch.
- Grade 5 will eat lunch at 12:28pm, then go to recess.
- Grade 6 will go to recess at 12:28pm, then come inside for lunch.

<u>Room #</u>	<u>Usage</u>		<u>Room #</u>	<u>Usage</u>
1	6th Grade Math/HEP(PM)		17	CST Office
2	6th - Writing		18	ESL./Speech Room (x2)
3	6th - Science		19	Band Room
4	6th - Reading		20	<i>Special Ed. Resource</i>
5	6th - Social Studies		21	<i>Special Ed. Resource</i>
6	6th - Math		22	4th Grade
7	Art (AM)/BSI (PM)		23	4th Grade
8	<i>Special Ed. Resource</i>		24	School Counselor's Office
9	Therapy Room (x2)		24A	Instr. Coach Office (x2)
10	3rd Grade		25	Nurse's Office
11	3rd Grade		26	4th Grade
12	3rd Grade		27	4th Grade
13	3rd Grade		28	<i>Special Ed. Resource</i>
14	3rd Grade		29	Interven. Office/BSI (x3)
15	Main Office		Trailer 1	5th Grade
15A	Principal's Office		Trailer 2	5th Grade
16	<i>Special Ed. Resource</i>		Trailer 3	5th Grade
16A	Media Center*		Trailer 4	5th Grade
16B	4th Grade			

Projected Room Usage at Churchill School

*Media Center is used for Media classes in the morning, then BSI instruction in the afternoon.

No Rooms*:
Music
World Language
STEAM

*These Special Area Teachers will be on a cart and travel from room to room.

Bold = Regular sized room

Winston S. Churchill School

